



THIS BULLETIN DOES NOT CHANGE AIRCRAFT TYPE DESIGN

SUBJECT: Mooney M20U and M20V Aircraft With Rudder/Brake Pedal Extensions Removed

MODELS/ SN **M20V** - S/N 33-0006, 33-0009

AFFECTED:

TIME OF COMPLIANCE: **Within next 10 Flight Hours**

INTRODUCTION: Mooney International Corporation has found the Rudder/Brake pedal not functioning properly, when the Pilot or Co-Pilot pedal extensions are removed, and installing the fixed brake pedal rod P/N 915052-000 on M20U and M20V Aircraft. Mooney Engineering has determined the use of a brake pedal rod P/N 915057-503 is required when the pedal extensions are removed.

INSTRUCTIONS: **Read entire procedures before beginning work.**

NOTE:

All work to be done in accordance with FAA AC43.13.

- 1.1. Turn the Master Switch off, and place aircraft on jacks per applicable Service and Maintenance Manual.
- 1.2. Remove engine cowling per applicable Service and Maintenance Manual.
- 1.3. On Pilot side, remove exhaust cavity panels from aircraft to access lower end of RH & LH rudder/brake pedal assembly, per applicable Service and Maintenance Manual.
- 1.4. Disconnect and remove both RH & LH 915025-000 rod assemblies at the pedal and at the bellcrank, remove from aircraft and discard, as shown in Figure SBM20-334-1.
 - a. From Pedal side, remove MS20392-2C61 PIN, NAS1149F0363P Washers (2) and MS24665-132 Cotter Pin, discard and use new upon installation.
 - b. From Pedal side, remove AN3-5A Bolt, NAS1149F0363P Washers and MS21042L3 Nut, discard and use new hardware upon installation.
 - c. From Bellcrank side, remove MS20392-2C13 Clevis Pin, NAS1149F0332P Washer and MS24665-132 Cotter Pin, discard and use new hardware upon installation.
- 1.5. Install both RH & LH 915057-503 rod assemblies as shown in Figure SBM20-334-1.
 - a. From Bellcrank side, install MS20392-2C13 Clevis Pin, NAS1149F0332P Washers and MS24665-132 Cotter Pin.
 - b. From Pedal side, install MS20392-2C61 Pin, NAS1149F0363P, NAS1149F0316P (Thin) Washer and MS24665-132 Cotter Pin in front holes as shown in Figure SBM20-334-1.
 - c. From Pedal side, install AN3-11A Bolt, NAS1149F0363P Washers and MS21042L3 Nut and torque per applicable Service and Maintenance Manual.
- 1.6. Repeat Steps on Co-Pilot Side.
- 1.7. Check brake pedal operation for smooth action and movement (no binding or sticking).
- 1.8. Install exhaust cavities on Pilot and Co-Pilot side of aircraft, seal cavities and removed skins with CS1900 Sealant, paint touch-up may be required, reference applicable Service and Maintenance and Illustrated Parts Catalog.
- 1.9. Re-Install engine cowling per applicable Service and Maintenance Manual.

NOTE:

Fill out compliance card and send by MAIL or FAX to Mooney International Corporation as indicated on the attached Compliance Card. (See Figure SBM20-334-1)

- 1.10. Return aircraft to service.
- 1.11. Procedure complete.



THIS BULLETIN DOES NOT CHANGE AIRCRAFT TYPE DESIGN

WARRANTY: Mooney International Corporation will warrant labor 6 hours when inspection is done in accordance with procedures of this Service Bulletin for aircraft currently covered under the Mooney International Corporation factory warranty program.

REFERENCE DATA: 1. Applicable Mooney Service and Maintenance Manual
2. Applicable Mooney Illustrated Parts Catalog

PARTS LIST: Mooney International Corporation, Service Bulletin Parts Kit(s): **SBM20-334-001**

(Parts List shown is for 1 Side - order 2 kits for both Pilot and Copilot brake install)

<u>Item</u>	<u>P/N</u>	<u>Description</u>	<u>Qty</u>
1	915057-503	Rod	2
2	AN3-11A	Bolt	2
3	NAS1149F0363P	Washer	6
4	MS21042L3	Nut	2
5	MS20392-2C61	Pin	2
6	NAS1149F0316P	Washer (Thin)	2
7	MS20392-2C13	Pin	2
8	NAS1149F0332P	Washer	4
9	MS24665-132	Cotter Pin	4
10	FLY0293	CS1900 Sealant (Pro Seal 700) 6 OZ.	1



THIS BULLETIN DOES NOT CHANGE AIRCRAFT TYPE DESIGN

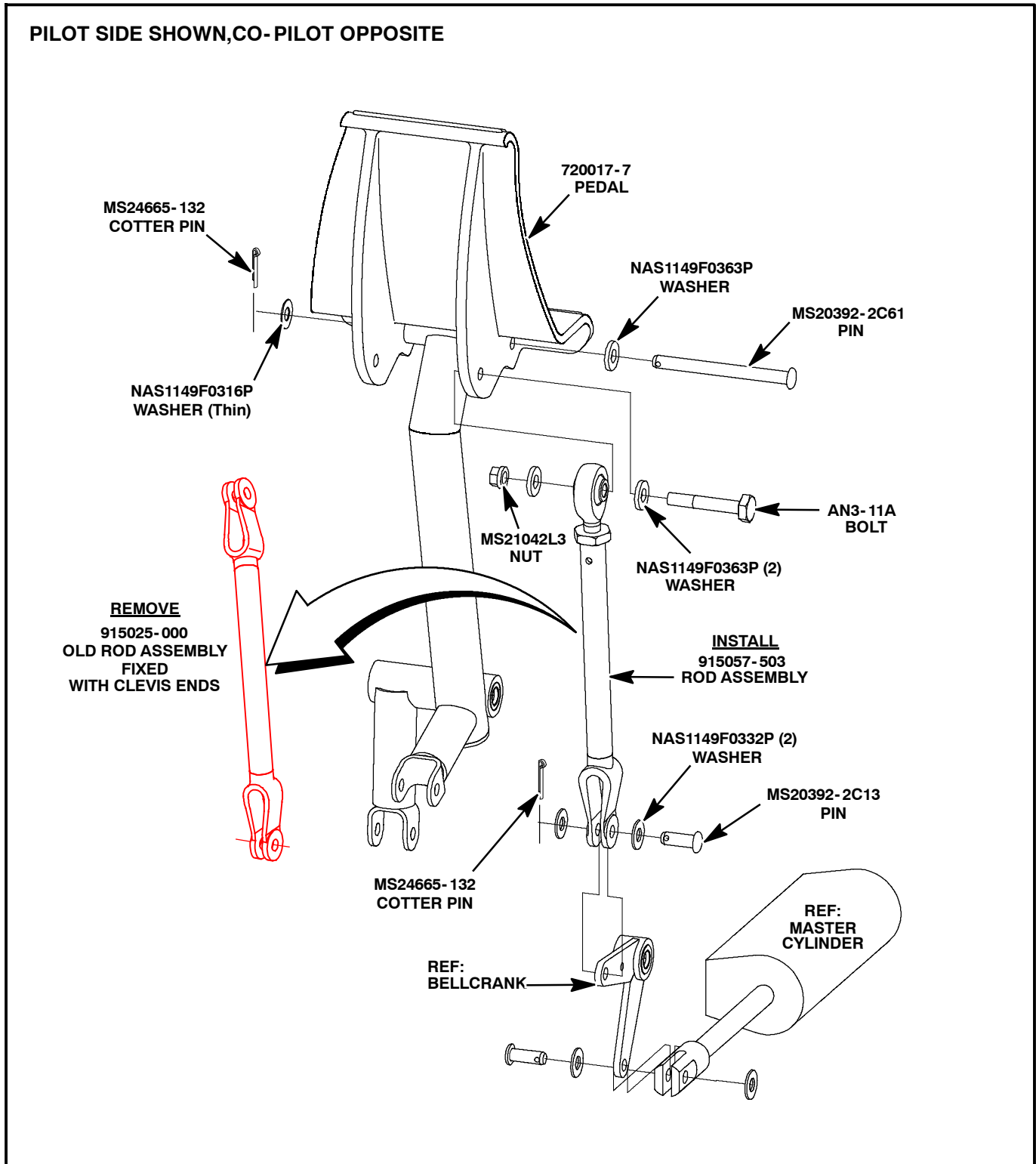

Figure SBM20-334-1 - REMOVING AND INSTALLING RUDDER/BRAKE PEDAL ROD



THIS BULLETIN DOES NOT CHANGE AIRCRAFT TYPE DESIGN

MOONEY INTERNATIONAL CORPORATION
KERRVILLE, TEXAS 78028 - FAX 830-257-4635

SERVICE (BULLETIN) (INSTRUCTION) NO. _____ HAS BEEN COMPLIED
WITH ON AIRCRAFT MODEL _____ SERIAL NUMBER _____

Tach. Time: _____ N-Number _____ (Reg. No.)
Owner: _____ Date of Compliance: _____
_____ Complied By: _____

Inspection Report: _____

Form 07-0001

PLACE
STAMP
HERE

MOONEY INTERNATIONAL CORPORATION
ATT'N: TECHNICAL SUPPORT
165 Al Mooney Road North
Kerrville, Texas 78028

SEND TO: Mooney International Corporation
165 Al Mooney Road North
Kerrville, TX 78028
FAX: (830) 257-4635 or EMAIL support@mooney.com

Figure SB M20-334-2 - Compliance Card